

#4097 PONTIAC GOLD PUMP KIT

- 1 - 240XL037 Belt
- 1 - 24XL037FP 24 Tooth Pulley
- 1 - 4013-5 Crankshaft Spud
- 1 - 4037-12 3/8 - 16x4 Bolt
- 2 - 4041-5 3/8 hard Washer
- 2 - 4042-3 3/8 - 16x2 3/4" Bolt
- 1 - 4042-5 5/8 - 18x4 Hex Bolt
- 1 - 4264P Stud Collar
- 1 - 48XL037 48 Tooth Pulley
- 1 - 5220 5/8 Hard Washer
- 1 - 5250 5/8 Lock Washer
- 1 - 5305 3/8 - 16x3 1/2" Bolt
- 2 - 5310 1 3/4" Spud Spacer
- 1 - 8501A Adj. Bracket
- 1 - 8510 Mounting Bracket
- 1 - 8600 3/8" Thick Washer

RON'S
FUEL INJECTION SYSTEMS
1-800-513-FUEL

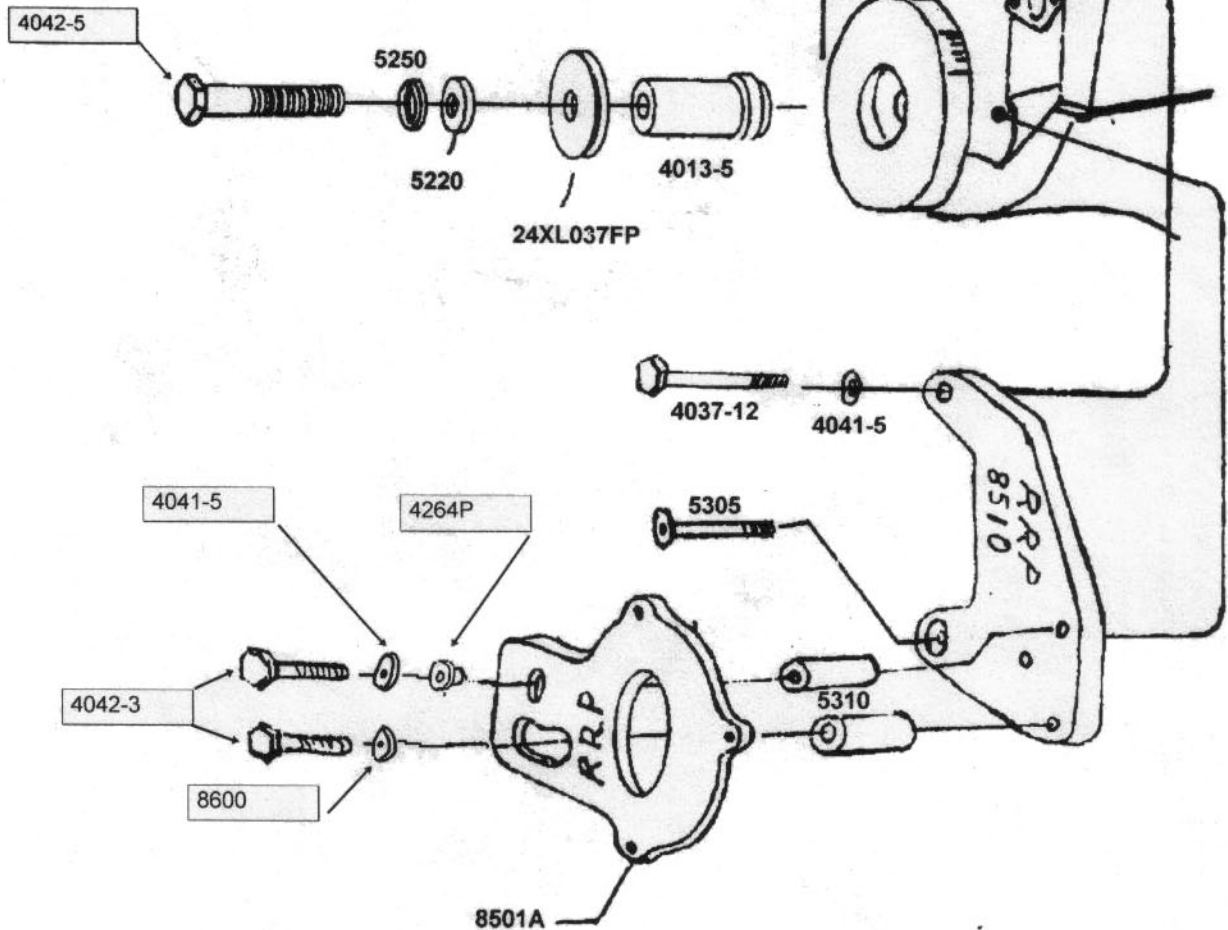

RON'S RECOMMENDS

To insure proper belt alignment, machine a 1.000" spot face where our #8510 bracket contacts the timing cover